

MANAGEBRIDGE

Launch notifications anywhere using your smart phone or tablet

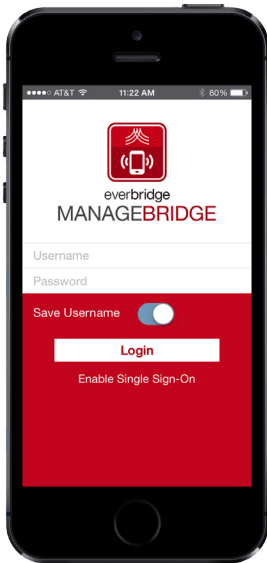

Single Sign-On

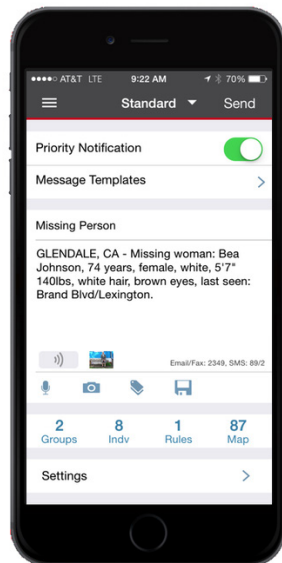

Send Notifications

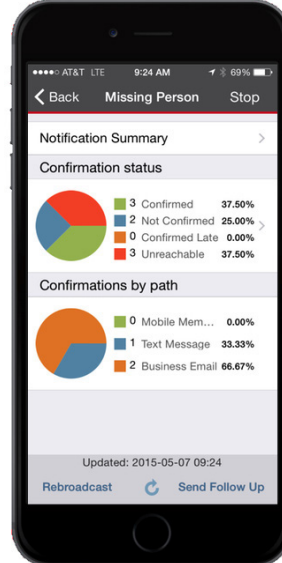

Run Report

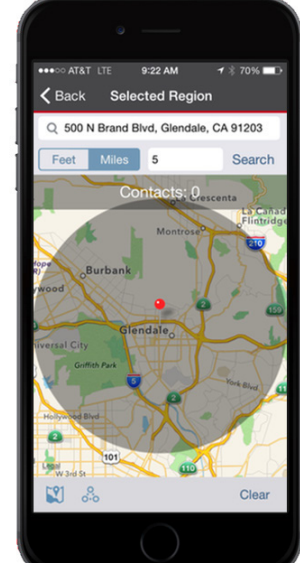

Select Contacts On Maps

MONITOR AND INITIATE COMMUNICATIONS ON-THE-GO

Everbridge **ManageBridge**, formerly Mobile Manager, brings the same set of rich communications features available in Mass Notification to administrators who frequently use mobile devices. With **ManageBridge**, users can monitor and initiate communications from smartphones and tablets while on-the-go.

ManageBridge is a free native mobile application available to Everbridge clients that gives them more control over their emergency notifications than ever before.

KEY BENEFITS

- + **REAL-TIME** - Provide instant updates and gather quick responses to assess what resources are needed and available
- + **CONNECTED** - Transmit SMS messages in low bandwidth or weak connectivity areas using Apple iOS and Android devices
- + **TARGETED** - Create specific stakeholder conference notifications to bring response teams and executives together, or launch secure push notifications on-the-fly
- + **INTERACTIVE** - Monitor real-time push notifications from mobile devices using an interactive graphical reporting interface

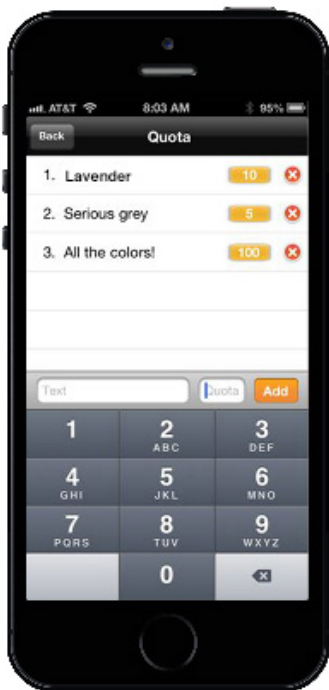

Quota Notifications

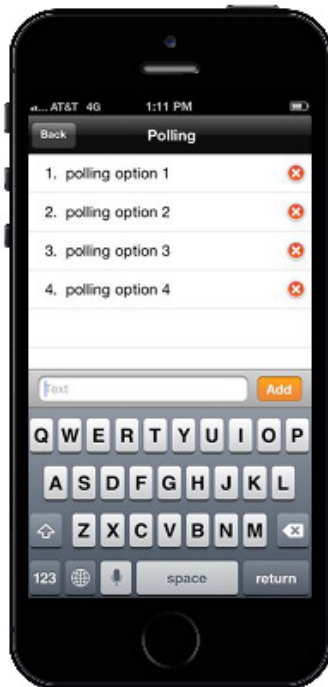

Polling Notifications

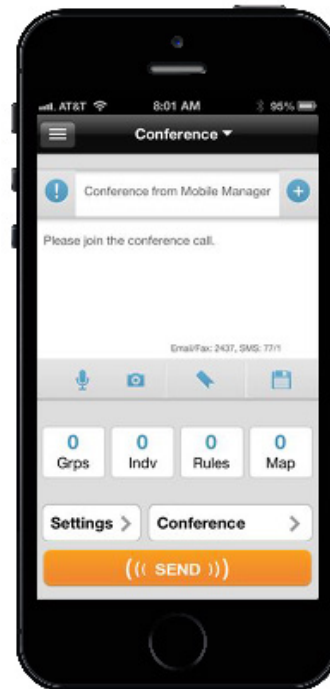

Conference Notifications

KEY FUNCTIONALITY

- + Access the Everbridge platform from Apple® iOS and Android™ devices
- + Launch secure notifications on-the-fly or from a template
- + Monitor real-time notifications through an interactive graphical reporting interface
- + Record a voice message and immediately send it to recipients or save it as a template
- + Attach an image from your smartphone or tablet to include with your notification

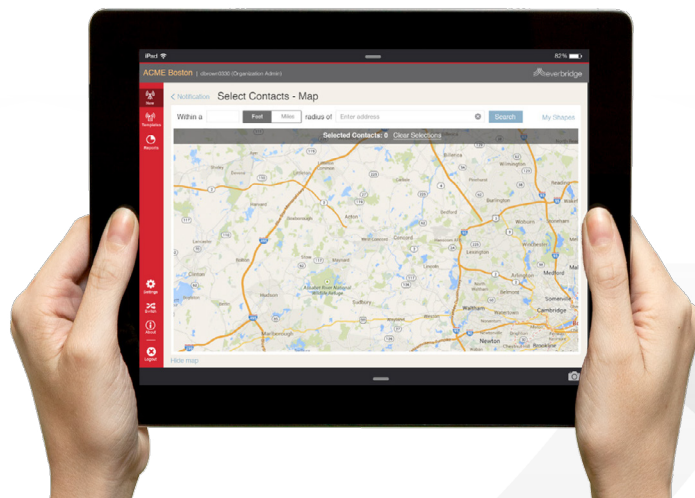

About Everbridge

Everbridge is a leading unified critical communications platform trusted by corporations and communities of all sizes that need to reach the right people for immediate action, collaboration, and decision-making. Connecting millions of people and internet-connected devices, the company provides reassurance that secure, compliant messages are delivered, locally and globally, received and responded to, no matter the recipient's location. Everbridge is based in Boston, Los Angeles, San Francisco, Beijing and London.

For a full product description, along with best practices and product details please see the Everbridge User Guide and Everbridge University.